

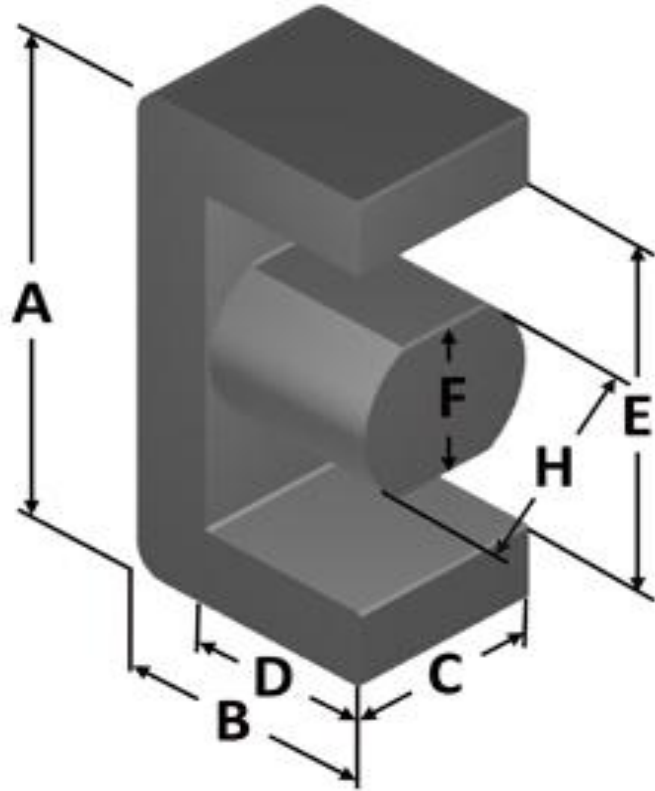

**Part Number:** **EM221-40/13**  
 Revision 20190524 - Generated 2019-May-30



<b>A</b>	56.13 ± 0.38 mm	2.210 ± 0.015 in
<b>B</b>	27.94 ± 0.19 mm	1.100 ± 0.008 in
<b>C</b>	27.18 ± 0.25 mm	1.070 ± 0.010 in
<b>D</b>	22.35 mm (nom.)	0.880 in (nom.)
<b>E</b>	44.70 mm (nom.)	1.760 in (nom.)
<b>F</b>	21.59 ± 0.25 mm	0.850 ± 0.010 in
<b>H</b>	21.59 ± 0.38 mm	0.850 ± 0.015 in
<b>Mass</b>	(approximate)	150 grams/half
<b>Magnetic Dimensions</b>	A <sub>e</sub> - Eff. Mag. Cross Section	3.22 cm <sup>2</sup>
	L <sub>e</sub> - Eff. Mag. Path Length	13.7 cm
	V <sub>e</sub> - Eff. Core Volume	44.0 cm <sup>3</sup>
	WA - Min. Eff. Window Area	5.11 cm <sup>2</sup>
	sa - Surface Area	144 cm <sup>2</sup>
	mlt - mean length per turn	14.4 cm
<b>Inductance</b>	μ <sub>i</sub> (reference)	60
	A <sub>L</sub> value (nominal)	188 nH/N <sup>2</sup>
	Test Winding	N=100, #18 AWG
	Frequency	100 kHz
	Voltage on Agilent 4284A	5.0 V
	A <sub>L</sub> tolerance	±10%
<b>Core Loss</b>	$\text{Core Loss (mW/cm}^3\text{)} = \frac{f}{\frac{a}{B_{pk}^3} + \frac{b}{B_{pk}^{2.3}} + \frac{c}{B_{pk}^{1.65}}} + d \cdot B_{pk}^2 \cdot f^2$	
	where B <sub>pk</sub> expressed in gauss, f expressed in hertz, and: a=1.10E+09, b=3.30E+07, c=2.50E+06, d=3.10E-13	
	B <sub>pk</sub>	140 G
	frequency	100 kHz
	Core Loss (nominal)	127 mW/cm <sup>3</sup>
Core Loss (maximum)	146 mW/cm <sup>3</sup>	
<b>DC Saturation</b>	$\% \mu_i = \frac{1}{a + b \cdot H^c} + d$	
	where H expressed in oersteds, and: a=1.00E-02, b=8.93E-06, c=1.61, d=0.00	
	H <sub>DC</sub>	50 Oe
	Percent Initial Perm(nom.)	67.0%
	Percent Initial Perm(min.)	60.2%
<b>Coating/Pkg</b>	Coating Type:	None, Green/Yellow Stripes
	Voltage Breakdown (min.)	N/A
	Limit	N/A
	Package Quantity	56 Halves/Box

<b>Winding Table</b>	<b>Wire Size</b>	AWG	8	10	12	14	16	18	20	22	24	26	28
		mm	3.150	2.500	2.000	1.600	1.250	1.000	0.800	0.630	0.500	0.400	0.315
	<b>Full Winding</b>	Turns	28	43	66	102	158	245	379	586	907	1,404	2,173
		Rdc(Ω)	8.3 m	20.2 m	49.3 m	121.3 m	298.8 m	736.9 m	1.8	4.5	11.0	27.0	66.5

