

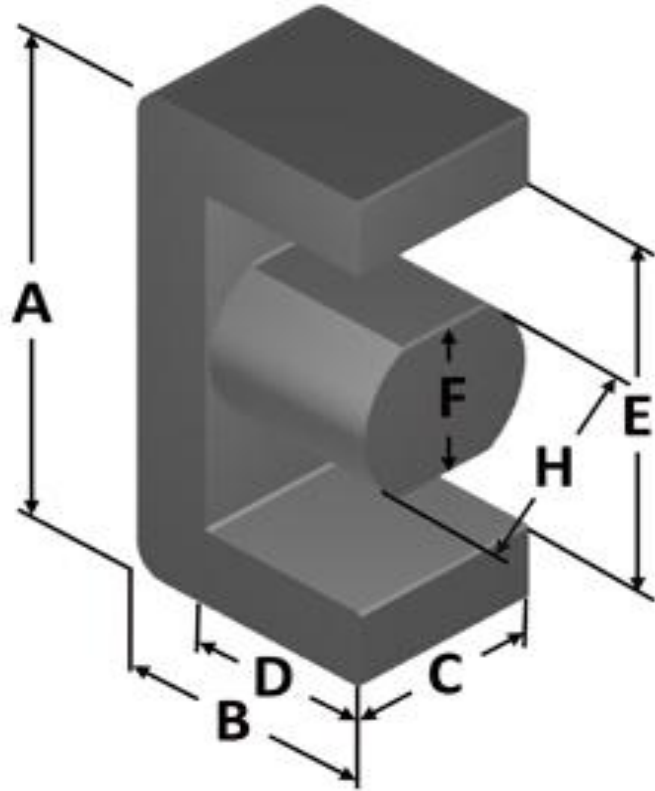

Part Number: EM169-40/G052/13
Revision 20190524 - Generated 2019-May-30



A	42.80 ± 0.38 mm	1.685 ± 0.015 in
B	21.01 ± 0.19 mm	0.827 ± 0.008 in
C	19.46 ± 0.25 mm	0.766 ± 0.010 in
D	15.29 mm (nom.)	0.602 in (nom.)
E	34.54 mm (nom.)	1.360 in (nom.)
F	14.73 ± 0.25 mm	0.580 ± 0.010 in
H	14.73 ± 0.38 mm	0.580 ± 0.015 in
Mass	(approximate)	61 grams/half
Magnetic Dimensions	A _e - Eff. Mag. Cross Section	1.79 cm ²
	L _e - Eff. Mag. Path Length	9.90 cm
	V _e - Eff. Core Volume	17.7 cm ³
	WA - Min. Eff. Window Area	2.99 cm ²
	sa - Surface Area	81.9 cm ²
	mlt - mean length per turn	10.8 cm
Inductance	μ _i (reference)	60
	A _L value (nominal)	61.3 nH/N ²
	Test Winding	N=100, #18 AWG
	Frequency	10 kHz
	Voltage on Agilent 4284A	0.79 V
	A _L tolerance	±10%
Core Loss	$\text{Core Loss (mW/cm}^3\text{)} = \frac{f}{\frac{a}{B_{pk}^3} + \frac{b}{B_{pk}^{2.3}} + \frac{c}{B_{pk}^{1.65}}} + d \cdot B_{pk}^2 \cdot f^2$	
	where B _{pk} expressed in gauss, f expressed in hertz, and: a=1.10E+09, b=3.30E+07, c=2.50E+06, d=3.10E-13	
	B _{pk}	140 G
	frequency	100 kHz
	Core Loss (nominal)	127 mW/cm ³
Core Loss (maximum)	146 mW/cm ³	
DC Saturation	$\% \mu_i = \frac{1}{a + b \cdot H^c} + d$	
	where H expressed in oersteds, and: a=1.00E-02, b=8.93E-06, c=1.61, d=0.00	
	H _{DC}	50 Oe
	Percent Initial Perm(nom.)	67.0%
Percent Initial Perm(min.)	60.2%	
Coating/Pkg	Coating Type:	None, Green/Yellow Stripes
	Voltage Breakdown (min.)	N/A
	Limit	N/A
	Package Quantity	155 Halves/Box

Winding Table	Wire Size	AWG	8	10	12	14	16	18	20	22	24	26	28
		mm	3.150	2.500	2.000	1.600	1.250	1.000	0.800	0.630	0.500	0.400	0.315
	Full Winding	Turns	16	25	39	60	93	143	222	343	531	822	1,272
	Rdc(Ω)	3.6 m	8.8 m	21.9 m	53.6 m	132.1 m	323.1 m	797.7 m	2.0	4.8	11.9	29.2	

